

77° LIFE

LIFE'S COMING TOGETHER.



CONSTRUCTION UPDATE – JUNE 2024

CONSTRUCTION SCHEDULE

MACRO SCHEDULE

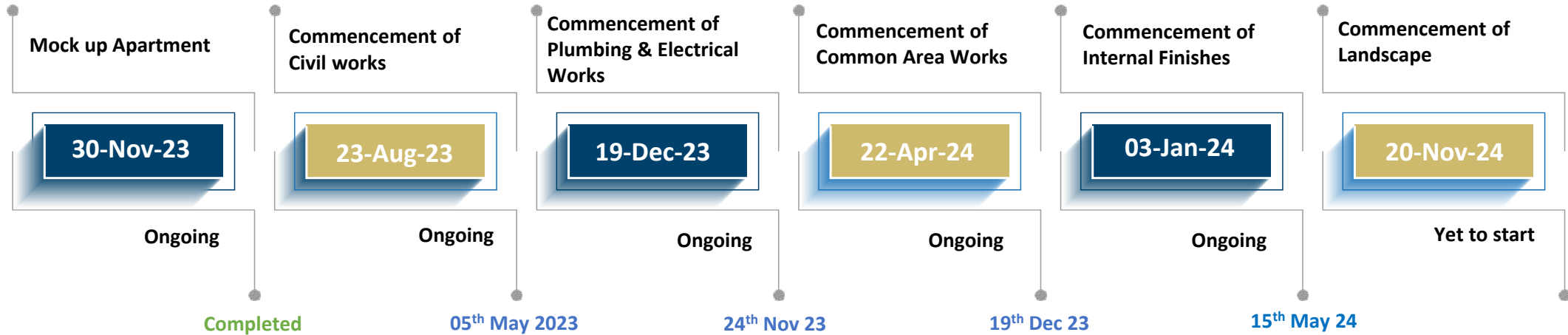

PAYMENT MILESTONES

TENTATIVE

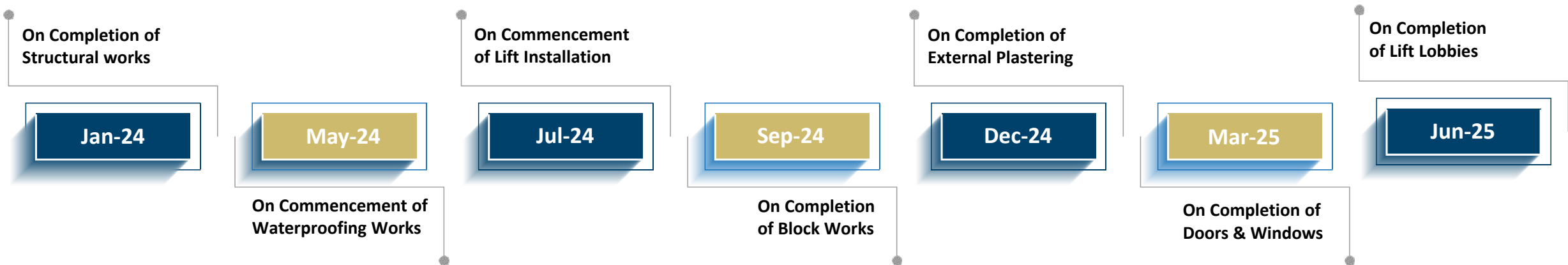

* The construction progress schedule presented in this report is subject to change based on evolving project conditions and unforeseen factors.

SPECIFICATION
UPGRADES

Flooring and Dado

All Bedrooms

Engineered Wooden Flooring

All Bathrooms

Flooring in Imported Marble, Dado in Premium Vitrified

Powder Rooms

Flooring in Imported Marble, Dado in Premium Vitrified

Plumbing and Bathroom Fixtures

Bathroom Counter

Imported Marble for the Counters

Kitchen Counter and Sink

Quartz Counter (uninstalled)

False Ceiling

Apartment

Gypsum False ceiling with LED concealed lighting as per default design

Toilet

Modular False Ceiling with Calcium Silicate Board Tiles or Equivalent

Power Supply; Electrical and Communication Systems

Wiring

Concealed FRLS Wiring in PVC conduits

Earthing

Earth Leakage Circuit Breaker (ELCB) and Miniature Circuit Breakers (MCB)

Doors and Windows

Main Door

8' Solid Core Double Leaf Doors with Designer Veneer

Internal Doors

7' Solid Core Veneered Flush Doors

Bathroom Doors

7' Solid Core Flush Doors with Veneer & laminate

Utilities & Services

Solar Water Heater

Provided as per M.O.E.F Norms (for Specific Apartments)

Elevators

Schindler or Equivalent

Security

Perimeter Cameras; 24/7 Patrolling, Access Control & Visitor Verification

* Specifications have been upgraded vis-à-vis the specifications declared on the RERA application / website.

KEY PLAN
2 DIMENSIONAL

Terrace:
Sky Zone Tennis
Court & Wellness
Deck

77° LIFE

Level 11 & 12
Ignis Zone
Social Deck

Level 7 & 8
Oasis Zone -
Kid's Entertainment
& Swimming Pool

Level 2
Terra Zone
Fitness & Indoor
Games

Level 1
Lobby Zone

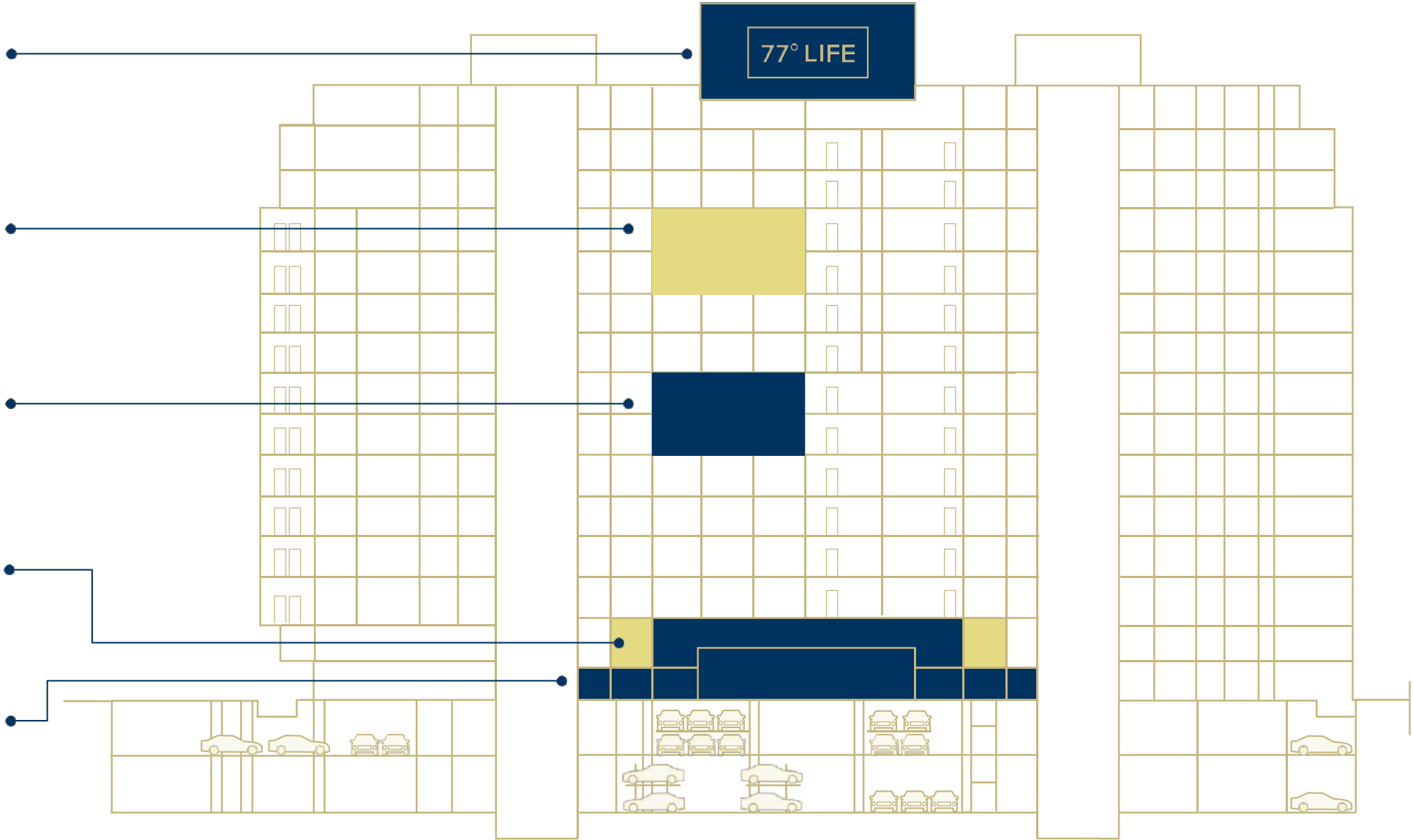

WATER PROOFING
IN PROGRESS

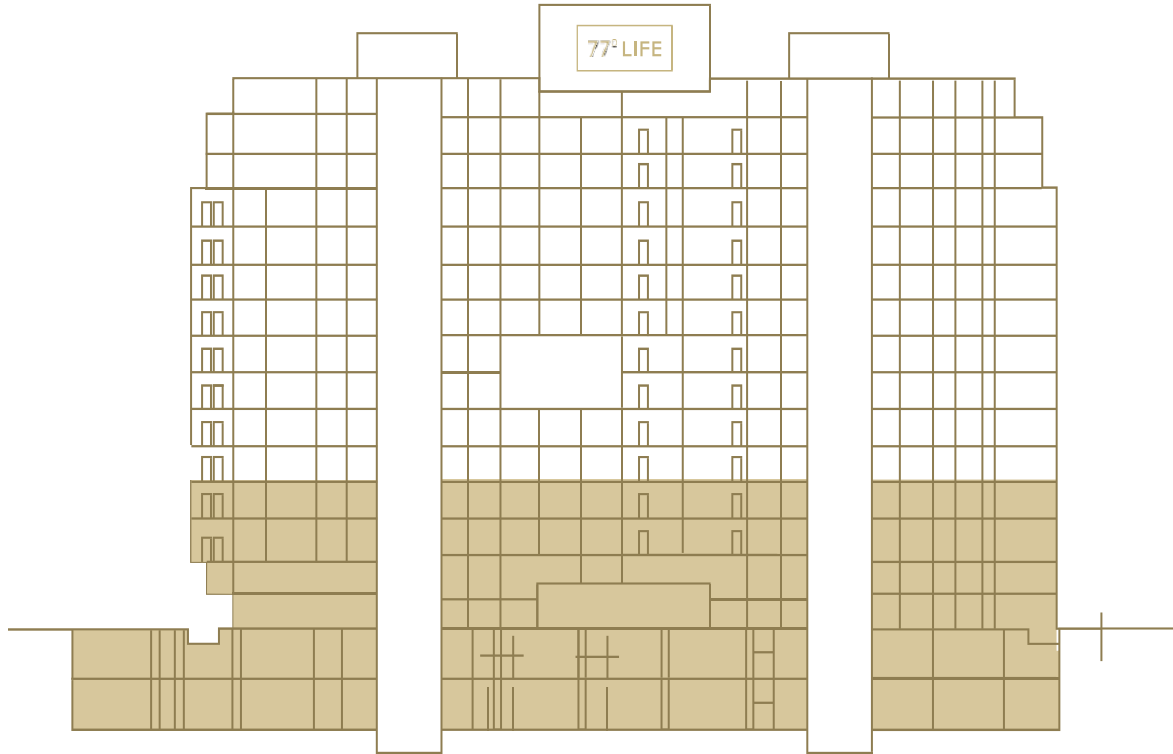

COMPLETED

BLOCK WORK
IN PROGRESS

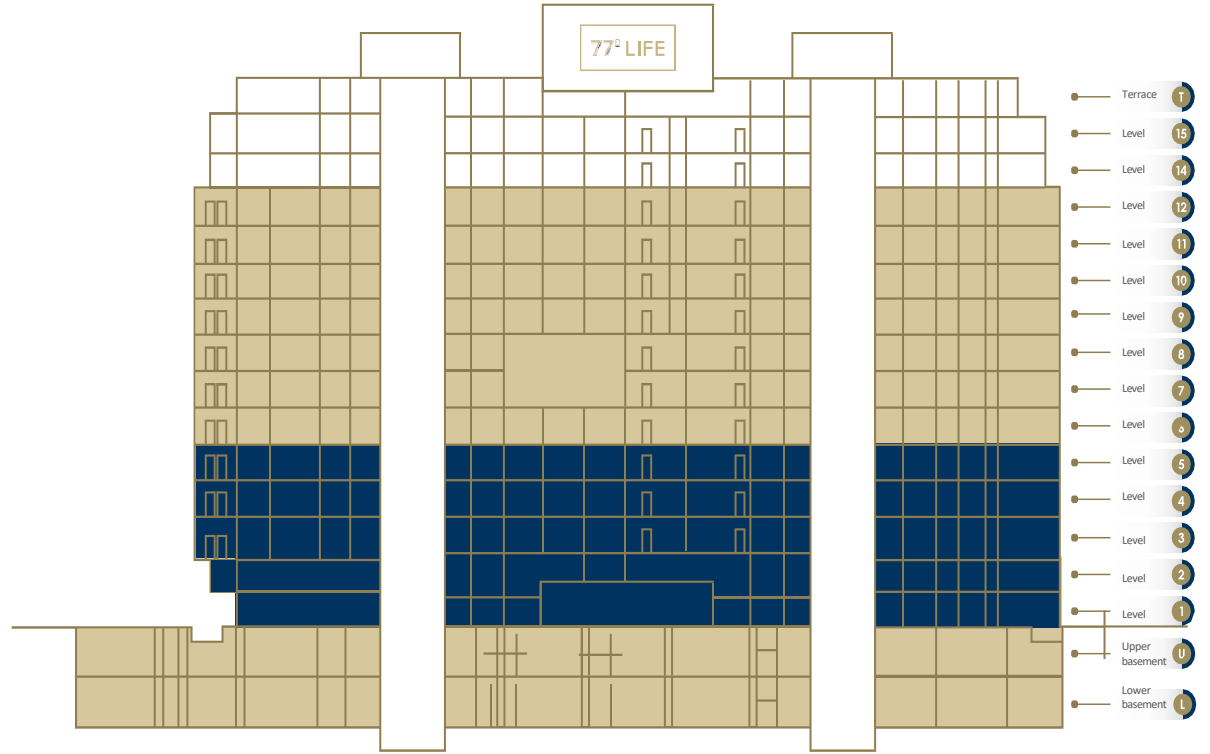

IN PROGRESS



Entrance Lobby – Cladding works in progress



Entrance Lobby – Water proofing works in progress



A 0109 – False Ceiling Works in Progress



A 0109 – Marble Works in Progress



A 0209 – False Ceiling works in Progress



A 0206 – Water Proofing works in Progress



A 0301 – Electrical works in Progress



A 0209 – Water Proofing works in Progress



A 1010 – Block works in Progress



A 1204 – Block works in Progress





Level 3 – PHE works in Progress



Level 4 – PHE works in Progress

PROJECT
ARTISTIC IMPRESSION OF AMENITIES





Squash is a high-energy racquet sport played in an enclosed court. Originating from early 19th-century England, the game evolved from a variant of the older sport, rackets. It gained popularity at Harrow School, where students discovered that punctured balls “squashed” on impact, leading to a slower and more tactical game.

Players compete by striking a small, hollow rubber ball against the front wall, aiming to outmaneuver their opponent. Matches are typically best of three or five games, with each game played to 11 points. Points are scored when an opponent fails to return the ball before it bounces twice or hits the ball out of play.

Squash demands agility, quick reflexes, and strategic shot placement, making it both physically and mentally challenging. The sport has a global following, with major tournaments like the British Open and PSA World Championships showcasing top talent. Despite not being an Olympic sport, squash remains celebrated for its intensity and the high level of skill it requires.

Do reach out to us in case you need any further information and / or clarification. We are happy to be of service!

Website:

www.77life.co.in

Phone:

+91 99002 48401

Mail:

crm@77towncentre.co.in

PRM/KA/RERA/1251/446/PR/211222/005551 For more detail visit <https://rera.karnataka.gov.in>.

The developer reserves the absolute right to change, omit, delete, add or revise amenities, specifications or any other details without notice.

Images used for representation purpose only. *T&C Apply